

Whiz Easy Set Up



Easy Set Up is...

EASY SET UP GETS **WHIZ TO**
AUTOMATICALLY CLEAN AN
AREA WITHIN A PREDEFINED
PERIMETER

Teach the perimeter (It has to be within 10m x 100m)



HOW DOES IT DO IT?

- The Whiz operator defines the boundary of the empty area.
- Once the perimeter is defined, the cobot automatically generates an area fill route inside the perimeter that maximizes the area to be cleaned.
- This generated route can then be used similar to a regular route for autonomy runs.

Automatically generates an area with a route inside the perimeter

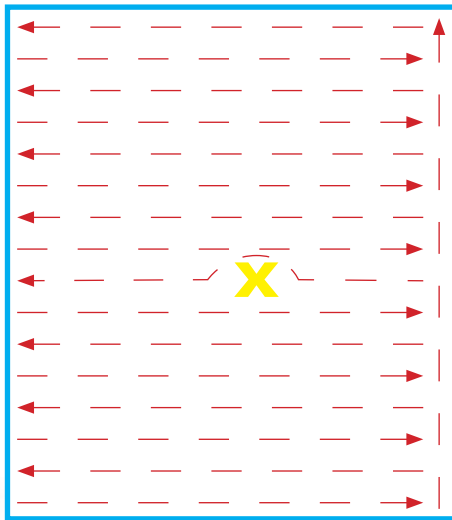

Autonomy runs with the auto-generated route

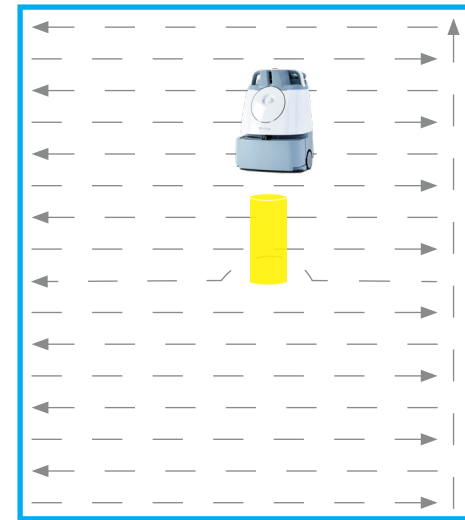

NOTE

Avoid obstacles on the perimeter and inside the area during training and autonomy runs where possible. For any other conditions, refer the following slides in this document.

Instructions to use Easy Set Up

EASY SETUP FUNCTION CAN BE USED BY SELECTING "TEACH BOUNDARY" ON A SELECT TEACH MODE SCREEN.

THE OPERATION AND SCREEN TRANSITION BEFORE AND AFTER THIS PAGE IS ALMOST THE SAME AS WHEN YOU TRAIN A ROUTE WITH MANUAL TEACHING MODE

PLEASE SEE THE DETAILED SCREEN SHOTS –

Tap "TEACH".

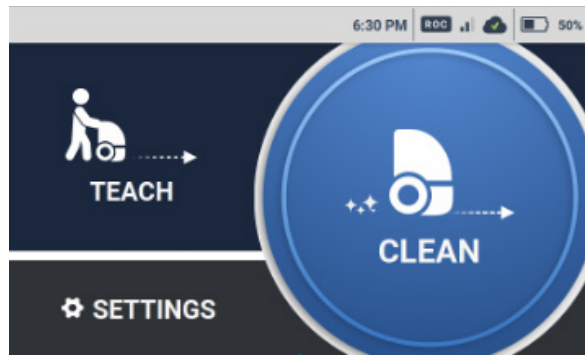

1

2

Choose desired slot to save.

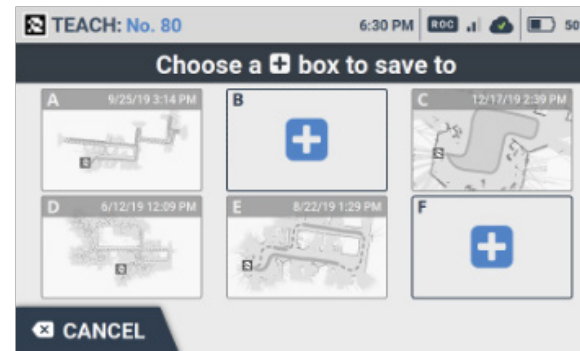

3

4

Start teaching boundary and save.

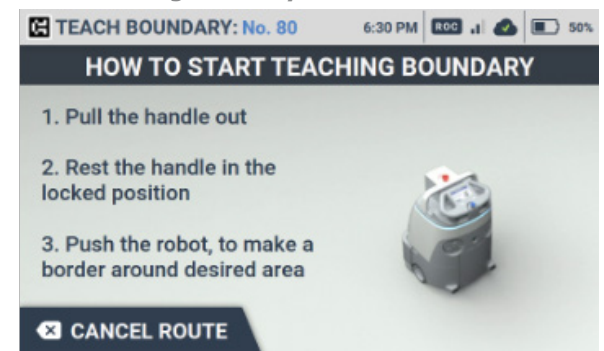

5

6

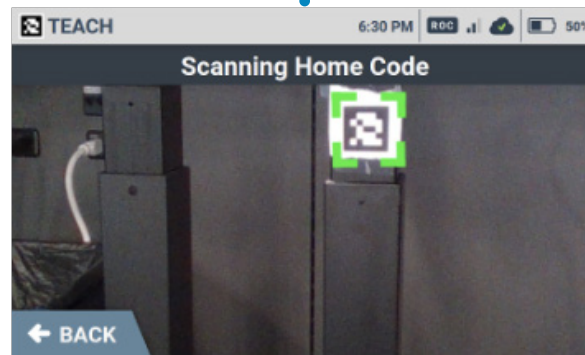

Scan HLC.

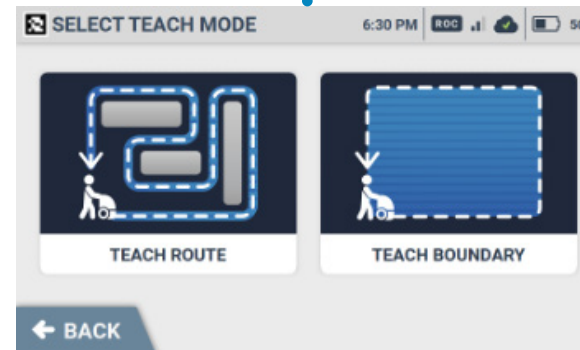

Tap "TEACH BOUNDARY".

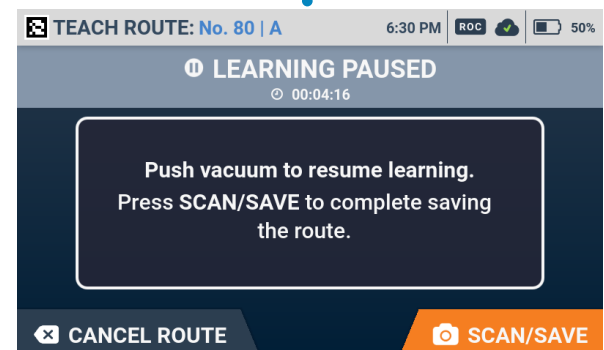

Press SCAN/SAVE to complete

Required Conditions

- Preferably operate in a large rectangular or square shaped space with a perimeter that is no more than 10m x 100m. Preferably operate in a large rectangular or square shaped space with a perimeter that is no more than 10m x 100m.
- Ensure there are as few obstacles as possible inside the perimeter being cleaned.

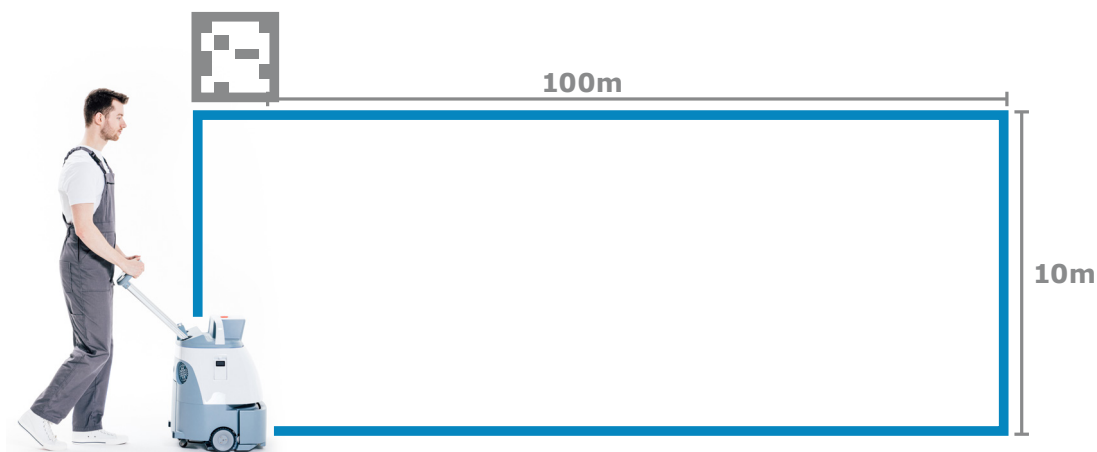

AS LONG AS A SHORT SIDE IS **LESS THAN 10 METRES**, A LONGER SIDE CAN BE UP TO 100 METER.

