

Whiz Set Up Checklist

Charge the Battery and insert it into the Machine

1 Charge the Battery

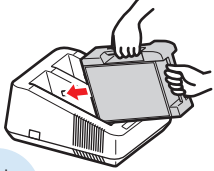

Check Charging Status

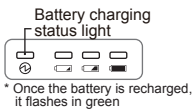

2 Insert the fully charged Battery into the Battery Compartment

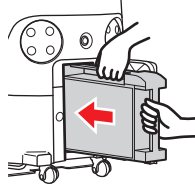

! Hold the handles with both hands and be careful not to drop it on the floor.

3 Lock the Battery, and close the Battery door

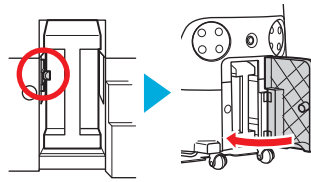

Release the Emergency Stop Button

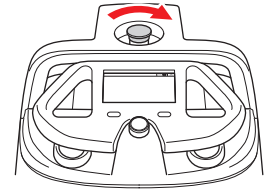

Turn the Emergency Stop Button to the right to release.

Check that the HEPA Filter, Dustbag and the Hopper Tray are Installed Correctly

HEPA Filter

1 To remove the filter cover, turn it to the left

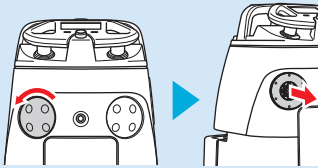

2 Turn the filter to the right until it clicks to close

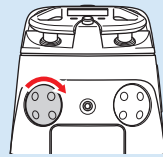

- ! Check the other HEPA filter with the same procedure.
- ! If the filter is not installed, install it into the Machine.

Dustbag

1 Open the Dustbin Cover

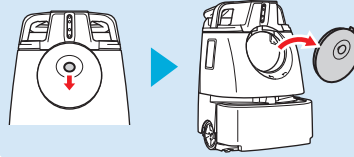

2 Check that the Dustbag is installed and the Dustbin pin is afloat

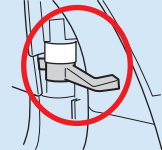

Hopper Tray

From the back of the machine, check if the Hopper Tray is installed correctly.

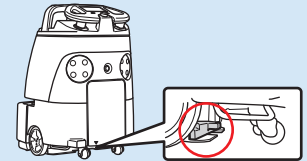

Attach the Brush

1 Stow the Steering Handle

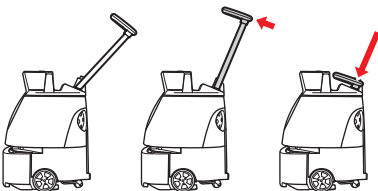

2 Hold the lift handles with one hand, and hold the steering handle down with another hand

! For safety precautions, operate with two people.

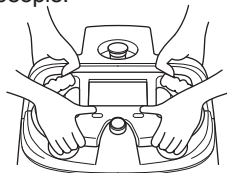

3 Gently lay the machine on its side so that the side with the dustbin is up

! Please be cautious so the handle does not stick out of the machine.

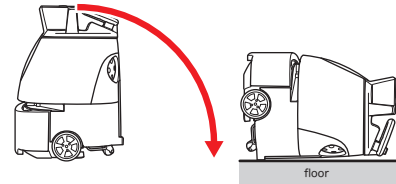

4 Attach the right side of the Brush to the socket of the Brush Compartment.

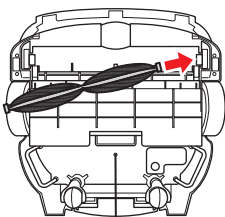

5 Press the Brush to the right and insert the left side of the Brush into the socket.

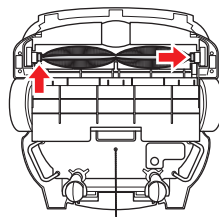

! When attaching the Brush, pay attention to the marks on each side of the Brush.

! Spin the Brush to check if it is installed correctly.

Left side

Right side

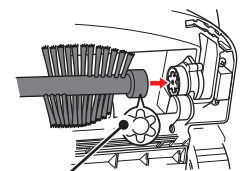
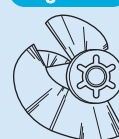

Right side

Remove the Protective Film from the Sensors

If any protective film is attached, remove the film before using the Machine.

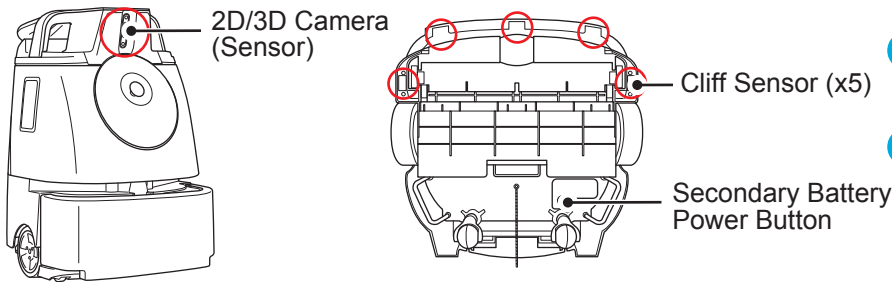

! Gently remove the film, being careful not to scratch the sensors.

! When removing the protective film from the sensors, check that the Secondary Battery Power Button is off.

? Be sure to turn off the Secondary Battery Power Button when using the Machine. When replacing the Battery during autonomous cleaning, turn on the Secondary Battery Power Button before replacing the Battery. Autonomous cleaning can be continued without turning the power off. After replacing the battery, turn off the Secondary Battery Power Button.

Check that it is Connected to Robot Operations Center (ROC)

1 Press the Main Power Switch to set it on (I)

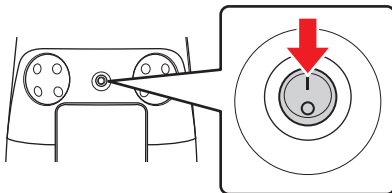

! A warning screen about escalators or other moving platforms appears. Check it and tap "CONFIRM".

2 Check that the Robot Operations Center connection icon(ROC) is displayed

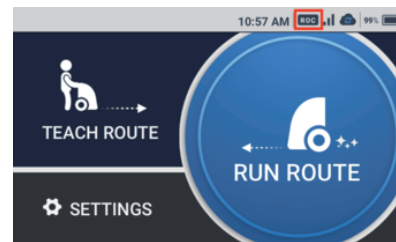

! If the connection icon does not appear, move the Machine to where it can be connected to the network.

Pair the Notification Pager

1 Open the battery door, and take out the accessory box

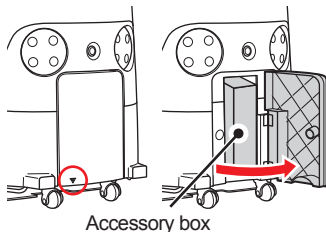

2 Turn the power button on

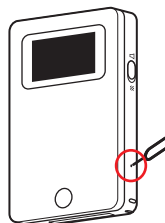

3 Press the main button for over 5 seconds

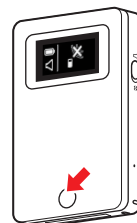

4 Check the pairing icon

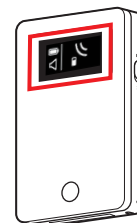

5 Attach the Pager to the pager holder

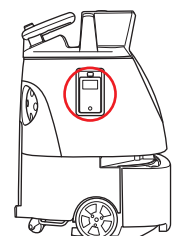

! Remove the Notification pager from the accessory box.

! Make sure the Machine is on (I) before pairing.

Check if BrainOS Software is the Latest Version

Tap "ABOUT" on the SETTINGS menu and check if the Machine is updated to its latest software. If it is not updated, leave the Machine on for over an hour in an environment where the Robot Operations Center (ROC) can be connected. (The Machine can be used during this time). Then, reboot the Machine and check the software version from the SETTINGS menu again.

